

MODEL: HM-308BN

AUTOMATIC GROMMETS INSERTING MACHINE

Feature:

- Automatic dual feeding of top and bottom pieces
- Use self-piercing grommets hole punching NOT NEEDED.

SPECIFICATION:

MOTOR: 1/4 HP

VOLTAGE: 110V 60HZ AC

THROAT DEPTH: 5"

WEIGHT: 400 LBS

PACKIN SIZE: 27"X29"X67"

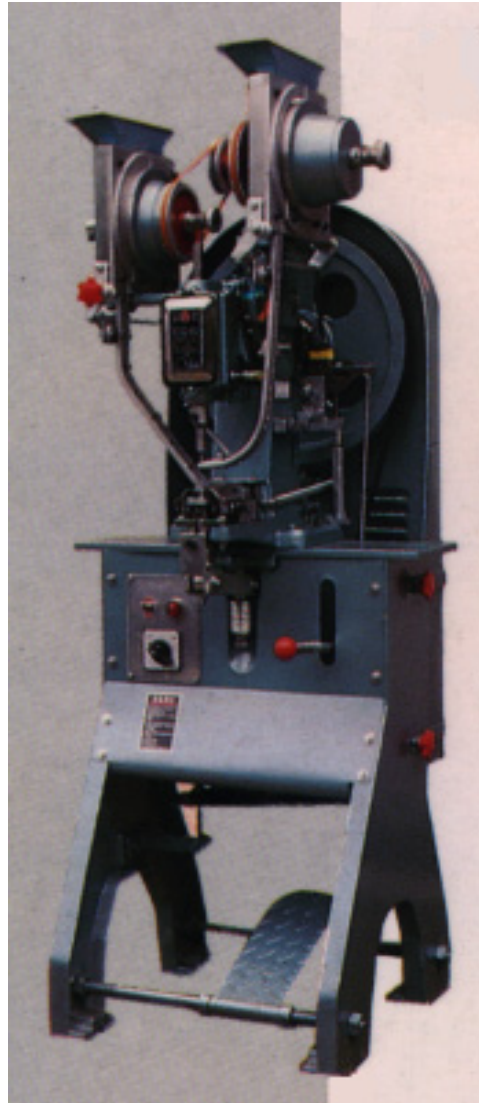

Hiker Enterprises Ltd.

107 Ferrier Street
Markham, Ontario,
Canada L3R 3K6
Tel: (905) 479-5390
Fax: (905) 479-0530
www.hikerenterprises.com

CONTENTS

BASE SUPPORT SYSTEM EXPLODED VIEW (FIG. 1)	4
PARTS LIST (FIG. 1)	5
DIES AND DIE SEATS LINKING SYSTEM EXPLODED VIEW (FIG. 2) ...	6
PARTS LIST (FIG. 2)	7
DIE AND DIE SEAT SYSTEM EXPLODED VIEW (FIG. 3)	8
PARTS LIST (FIG. 3)	9
PUSHER SYSTEM EXPLODED VIEW (FIG. 4)	10
PARTS LIST (FIG. 4)	11
BODY, PULLEY AND MAIN SHAFT EXPLODED VIEW (FIG. 5)	12
PARTS LIST (FIG. 5)	13
SAFETY DEVICE SYSTEM EXPLODED VIEW (FIG. 6)	14
PARTS LIST (FIG. 6)	15
CLUTCH CONTROL SYSTEM EXPLODED VIEW (FIG. 7)	16
PARTS LIST (FIG. 7)	17
CLUTCH SYSTEM EXPLODED VIEW [OLD TYPE] (FIG. 8)	18
PARTS LIST (FIG. 8)	19
CLUTCH SYSTEM EXPLODED VIEW [NEW TYPE] (FIG. 9)	20
PARTS LIST (FIG. 9)	21
HEAD, COMPONENT CASE SYSTEM EXPLODED VIEW (FIG. 10)	22
PARTS LIST (FIG. 10)	23
RIGHT FEEDING SYSTEM EXPLODED VIEW (FIG. 11)	24
PARTS LIST (FIG. 11)	25
LEFT FEEDING SYSTEM EXPLODED VIEW (FIG. 12)	26
PARTS LIST (FIG. 12)	27
ASSEMBLIES REPLACEMENT (FIG 13)	28
PARTS LIST (FIG. 13)	29
NORMAL WARNOUT PARTS LIST	30
WIRE DIRGRAM	31

INTRODUCTION

THIS BOOKLET IS PUBLISHED BY HIKER ENTERPRISES CO., LTD. TO PROVIDE THE USERS WHO HAVE PURCHASED THE HM-208B MACHINES FOR PERFORMANCE AND PARTS SUPPLY.

THIS MACHINE IS A FULL-AUTOMATIC SAFETY FASTENING MACHINE, ITS SPEED AS WELL AS SAFETY IS PERFECT. OUR PRODUCTS HAVE GOOD SALE, COMMENTS AND CONFIDENCE FROM THE USERS OF HOME AND ABROAD RECENTLY FOR A DECADE.

GENERAL DESCRIPTION

1. DATA :

- (1) MOTOR : 1/4 HP
- (2) VOLTAGE : 110V 、 220V 、 3PH 、 50~60HZ.
- (3) SUITABLE : TUBULAR RIVETS, SNAPS, PLASTIC BUTTONS, SNAPPER FASTENERS, PRONGS, TACKS.
- (4) PIECEWORK : RAINCOAT, GARMENT, STATIONERY, RUBBER ITEMS, PLASTIC ITEMS, LEATHER BAGS.
- (5) THROAT DEPTH : 5"
- (6) GROSS WEIGHT : 240KG
- (7) PACKING SIZE : 27"×29"×67"

2. CAUTION :

- (1) IN THE CASE OF CHANGING OTHER KIND OF SNAP BUTTONS, SHOULD CHANGE A COMPLETE SET OF FEEDING SYSTEM TO FIT BUTTONS SIZE WHICH YOU DESIRE.

- (2) BEFORE OPERATING, YOU SHOULD CHECK THE VOTAGE AS YOUR MOTER'S.
- (3) BEFORE SWITCHING THE POWER, YOU SHOULD CHECK THE PROPER DISTANCE BETWEEN UPPER AND LOWER DIES BY TURNING THE FLYWHEEL IN ONE COMPLETE TURN WITH HAND.
- (4) TO DROP THE OIL INTO THE HOLES TO LUBRICATE THE MOVING PART, AND PUT THE GREASE INTO THE CUP.
- (5) WORNOUT PARTS MUST BE RESUPPLIED FROM OUR COMPANY AS YOU SEND TO US THE CORRECT PART NUMBERS, AS SHOWN A-15 \ B-03 AS SOON AS POSSIBLE.

ORDERING REPLACEMENT PARTS

ALL PARTS OF THIS MACHINE HAVE BEEN ASSIGNED PARTS NUMBER IN THE CATALOG BOOK. THESE PARTS ARE SHOWN IN THE EXPLDED VIEW DRAWINGS.

WHEN ORDERING ANY PART, THE FOLLOWING INFORMATION MUST BE SUPPLIED :

- A. YOUR COMPANY'S NAME AND ADDRESS.
- B. MACHINE MODEL AND SERIAL NUMBER.
LOCATED ON NAME PLATE OF MACHINE.
- C. THE STYLE AND CARD NUMBER OF THE
FASTENERS BEING USED.
- D. WRITE DOWN FIG. NO., LTEM NO. AND PART NO. NAME OF PART
DESIRED, UNIT AND QUANTITY. THOSE OF WHICH ARE SHOWN IN
THE CATALOG BOOK.
- E. IF POSSIBLE, RETURN WORN OR BROKEN PART WITH YOUR
PURCHASE ORDER WHEN YOU ARE NOT SURE.

BASE SUPPORT SYSTEM EXPLODED VIEW (FIG. 1)

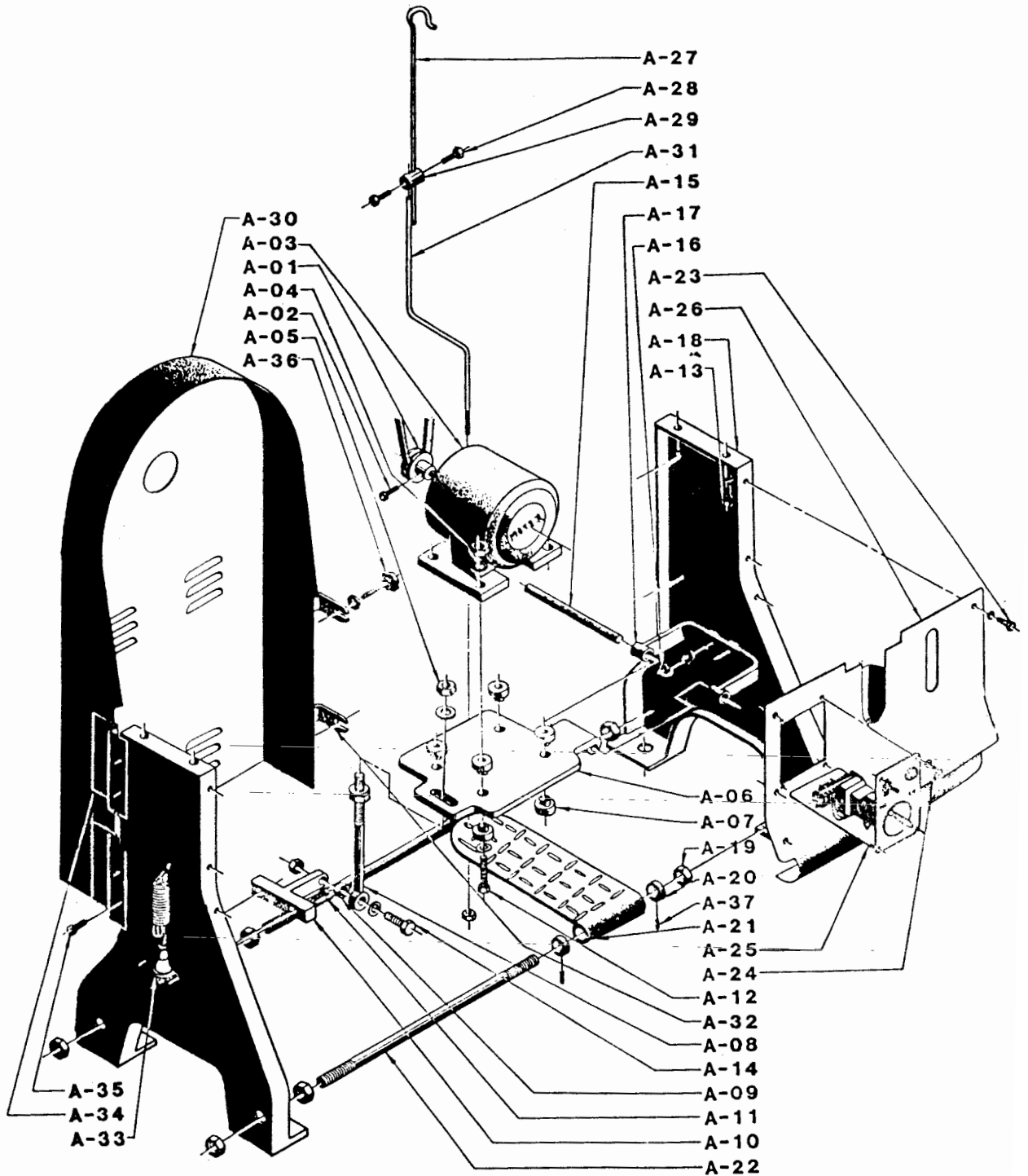

HIKER

Figure 1. Parts List

ITEM NO.	DESCRIPTION	QTY	REMARKS
A-01	MOTOR PULLEY	1	
A-02	SET SCREW MOTOR PULLEY	1	5/16" ^φ x 3/4" L
A-03	MOTOR	1	
A-04	NUT	4	
A-05	NUT	2	
A-06	MOTOR BEARER	1	
A-07	RUBBER WASHER	8	
A-08	BEARER SUPPORTING ROD	1	
A-09	NUT	2	
A-10	HOLDER, BEARER SUPPORTING ROD	1	
A-11	FIXED SCREW	2	3/8" ^φ x 3/4" L
A-12	FIXED SCREW, MOTOR	4	5/16" ^φ x 1 1/2" L
A-13	FIXED SCREW	4	3/8" ^φ x 1" L
A-14	SCREW, MOTOR BEARER SUPPORTING ROD	1	
A-15	PIN, MOTOR BEARER	1	
A-16	FIXED SCREW	2	3/8" ^φ x 1 1/2" L
A-17	PIN HOLDER, MOTOR BEARER	1	
A-18	BASE SUPPORT, RIGHT	1	
A-19	NUT	8	
A-20	STOP RING PEDAL	2	3/4" ^φ x 1 1/4" Φ16t
A-21	PEDAL	1	
A-22	CROSS BAR, BASE SUPPORT	2	
A-23	FIXED SCREW	6	1/4" ^φ x 1 1/2" L
A-24	FIXED SCREW	4	3/16" ^φ x 1 1/2" L
A-25	POWER SWITCH PLATE	1	
A-26	FRONT PANEL	1	
A-27	UPPER TREADLE ROD	1	
A-28	FIXED SCREW	2	5/16" ^φ x 1 1/2" L
A-29	CONNECTOR, LOWER AND UPPER PEDAL ROD	1	
A-30	FLYWHEEL COVER	1	
A-31	LOWER TREADLE ROD	1	
A-32	LOCK PLATE, FLYWHEEL	2	
A-33	POWER PLUG	1	
A-34	HINGE, FLYWHEEL COVER	2	
A-35	FIXED SCREWS	6	1/4" ^φ x 1 1/2" L
A-36	FIXED SCREWS	2	
A-37	FIXED SCREWS	2	

DIES AND DIE SEATS LINKING SYSTEM EXPLODED VIEW (FIG. 2)

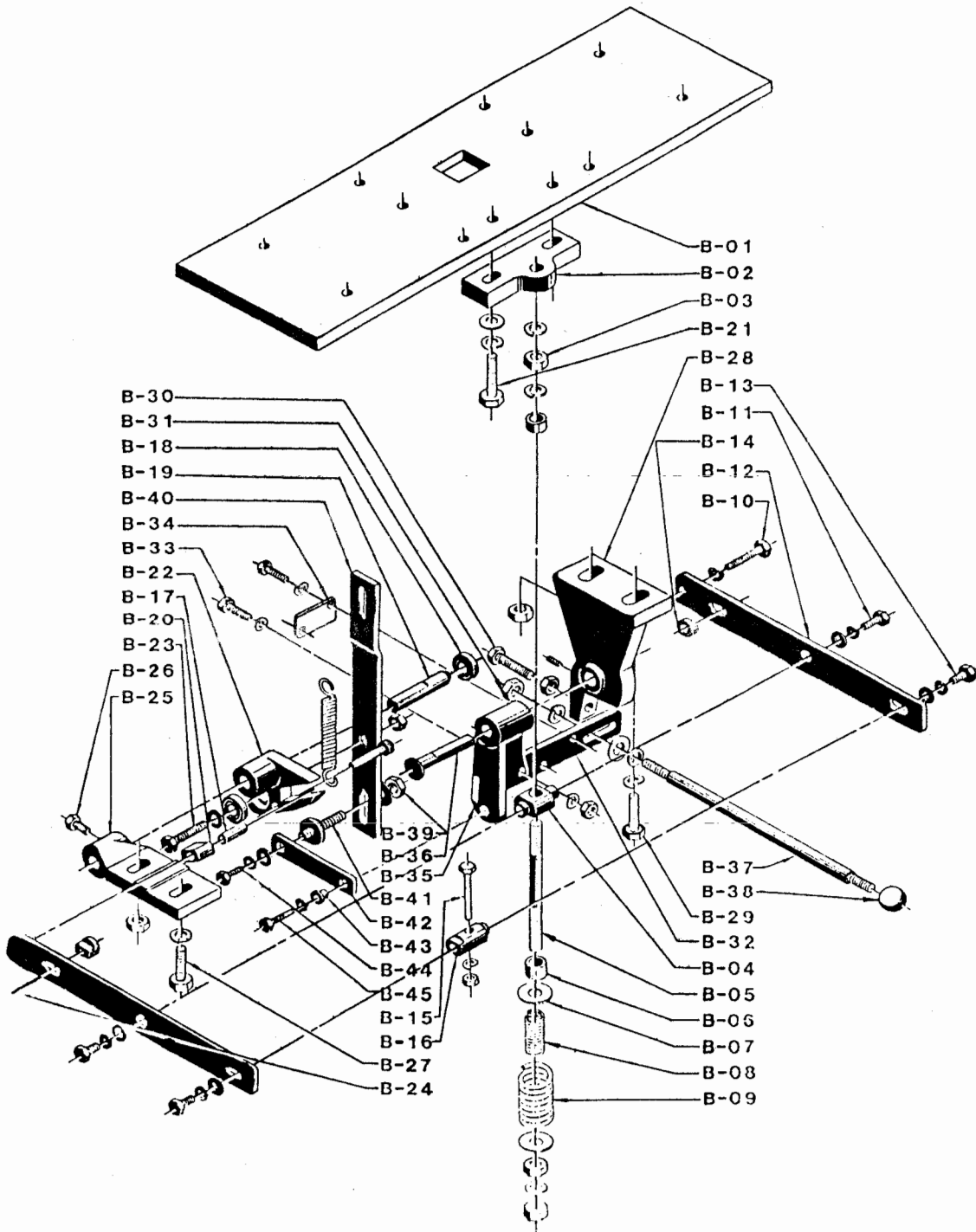

HIKER

Figure 2 Parts List

ITEM NO	DESCRIPTION	QTY	REMARKS
B-01	WORK BENCH	1	
B-02	TAPPET STOP PLATE	1	
B-03	NUT	3	
B-04	JOINT, FULCRUM ROD	1	
B-05	FULCRUM ROD	1	1/2"φ x 1401L
B-06	COLLAR, FULCRUM ROD	1	
B-07	FLAT WASHER	3	
B-08	AUXILIARY COIL SPRING	1	4.6 x 8 x 70.4L x 9φ
B-09	MAIN COIL SPRING FULCRUM ROD	1	6 x 11 x 67 x 7φ
B-10	TAPPET ARM SCREW	1	
B-11	SCREW	2	
B-12	TAPPET ARM	2	
B-13	SCREW	2	1/4"φ x 1 1/2"L
B-14	BUSHING-SHAFT	2	3/8"φ INSIDE DIA
B-15	TAPPET ADJUSTING SCREW	1	3/8"φ x 2"L
B-16	TAPPET ADJUSTER	1	
B-17	BUSHING-SHAFT PIPE	1	
B-18	BEARING	2	6000#, 26φ x 10φ x 8t
B-19	SHAFT PIN, OSCILLATING HEAD	1	5/8"φ
B-20	SLIDING KEY, OSCILLATING HEAD	1	
B-21	FIXED SCREW	2	3/8"φ x 1 1/2"L
B-22	OSCILLATING HEAD	1	
B-23	SCREW	1	5/16"φ x 1 1/4"L
B-24	ROCKER ARM PIN	1	5/16"φ x 50L
B-25	HANGING BRACKET	1	
B-26	FIXED SCREW	1	5/16"φ x 3/4"L
B-27	FIXED SCREW	2	
B-28	LINK PUSHING BRACKET	1	
B-29	FIXED SCREW	1	
B-30	ADJUSTING SCREW, PUSHING PLATE	1	5/16"φ x 2"L
B-31	NUT	1	
B-32	PUSHING PLATE	1	
B-33	FIXED SCREW	1	3/8"φ x 1 1/4"L
B-34	WASHER	1	50 x 30 x 1/8"t
B-35	PUSHER LINK PIECE	1	
B-36	PUSHER SHAFT	1	
B-37	HAND PUSHING ROD	1	
B-38	KNOB, HAND PUSHING ROD	1	
B-39	NUT	1	
B-40	ROCKER ARM	1	
B-41	ADJUSTING SHAFT	1	
B-42	CONNECTING PLATE	1	
B-43	BUSHING-SHAFT CONNECTING PLATE	1	
B-44	SCREW	1	1/4"φ x 1/2"L
B-45	SCREW	1	5/16"φ x 1 1/4"L

DIE AND DIE SEAT SYSTEM EXPLODED
VIEW (FIG. 3)

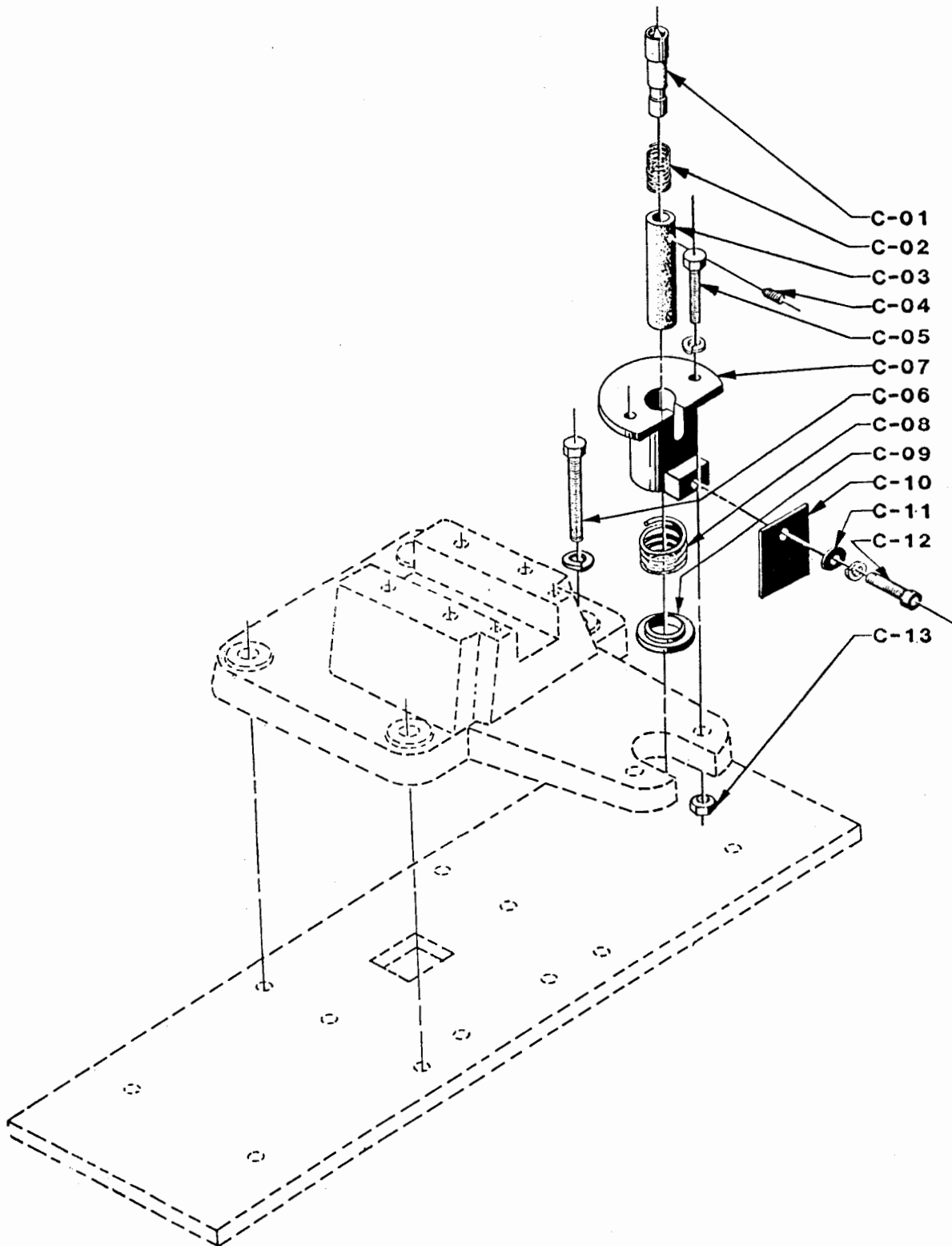

HIKER**Figure 3****Parts List**

ITEM NO.	DESCRIPTION	QTY	REMARKS
C-01	DIE (SIZES ARE REPLACEABLE)	1	
C-02	SPRING, DIE	1	1 x 66 x 3.5 x 19
C-03	PIPE SOCKET, DIE	1	
C-04	SETCREW, DIE PIPE SOCKET	1	1/4"φ x 3/4"
C-05	SCREW, DIE SEAT	2	5/16"φ x 2"
C-06	SCREW , PUSHER SLOT, BASE	4	3/8"φ x 3"
C-07	GUIDE-WAYS BASE	1	
C-08	COIL SPRING	1	3 x 37φ x 60x 14 x 5
C-09	SEAT, COIL SPRING	1	
C-10	SIDE PLATE, DIE SEAT	1	
C-11	FLAT WASHER	1	
C-12	SOCKET HEAD SCREW SIDE PLATE	1	5/16"φ x 3/4"
C-13	NUT, DIE SEAT SCREW	2	

PUSHER SYSTEM EXPLODED VIEW

(FIG. 4)

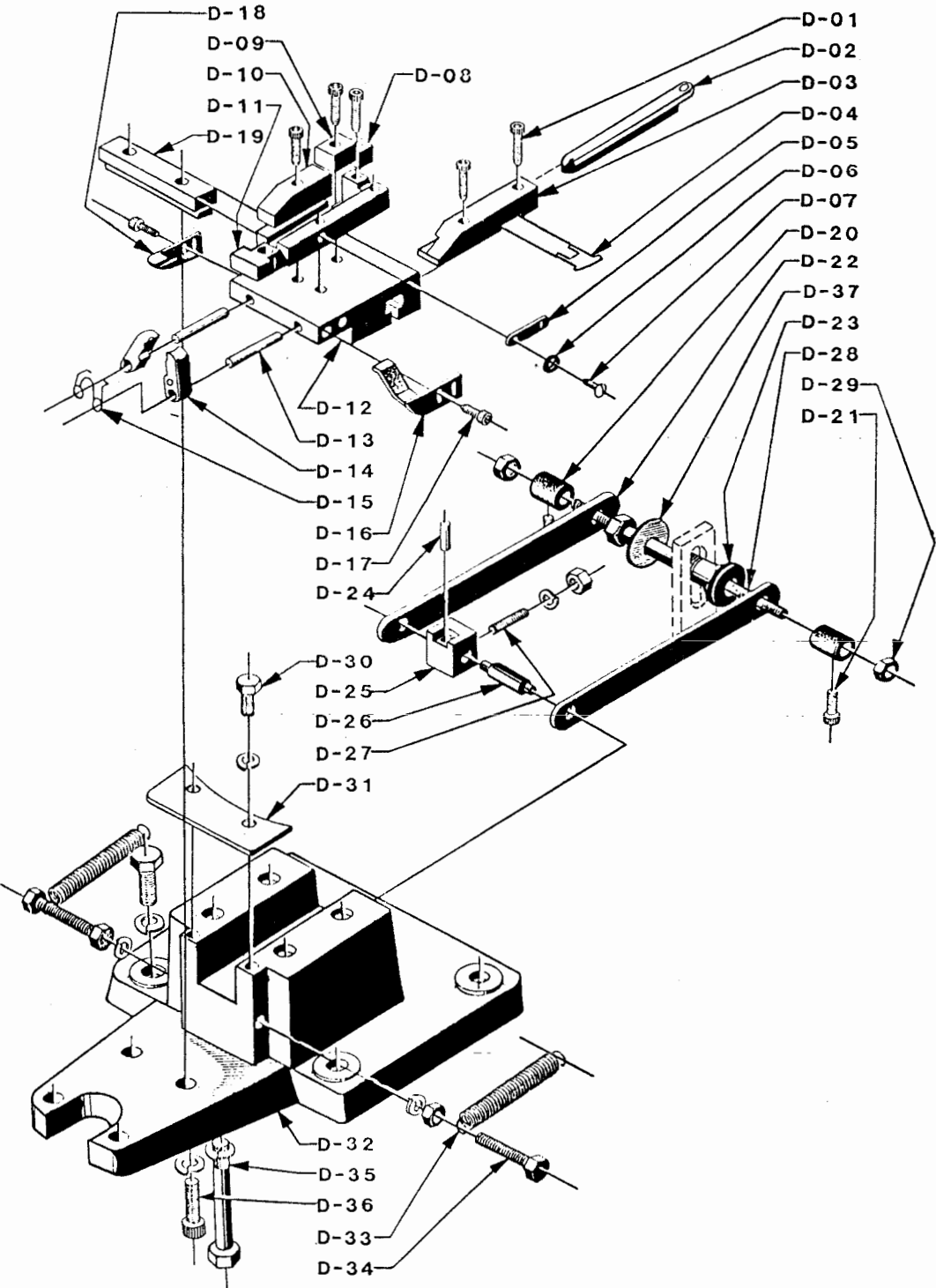

HIKER

Figure 4 Parts List

ITEM NO	DESCRIPTION	QTY	REMARKS
D-01	SOCKET CAP SCREW, GUIDE BLOCKS	4	3/16" ^φ x 1 1/4" L
D-02	SNAP PUSHING ROD	1	
D-03	GUIDE BLOCK, SNAP PUSHING ROD	1	
D-04	CONTROL SLICE, TRACK FEEDINGS	1	
D-05	SPRING LEAF, CONTROL SLICE	1	
D-06	WASHER	1	
D-07	SPRING LEAF SCREW	1	3/16" ^φ x 1 1/4" L
D-08	SQUARE BLOCK, SIDE	1	
D-09	SQUARE BLOCK, MIDDLE	1	
D-10	GUIDE BLOCK, TRACK	1	
D-11	GUIDE-WAYS SEAT	1	
D-12	MILLING BENCH(FOR PRONG EYE-LET)	1	
D-13	JAW PIN	2	5 ^φ x 45L
D-14	LOWER JAW	1	
D-15	JAW SPRING	1	
D-16	JAW COVER	1	
D-17	SCREWS	2	1/4" ^φ x 1/2" L
D-18	JAW COVER	1	
D-19	SLOT KEY, MILLING BENCH	1	
D-20	SLEEVE, SLIDING ARM	2	3/4" ^φ x 1/2" L
D-21	SCREWS	2	1/4" ^φ x 1/2" L
D-22	SLIDING ARM	2	
D-23	ADJUSTER	1	
D-24	PIN, SNAP PUSHING ROD	1	
D-25	MOVING PIVOT, SNAP PUSHING ROD	1	
D-26	PIN, MOVING PIVOT	1	
D-27	THREAD PIN, MOVING PIVOT	1	5 ^φ x 24L
D-28	SLIDING ARM PIN	1	
D-29	NUTS	2	5/16" ^φ x 6t
D-30	SCREWS	2	1/4" ^φ x 1/2" L
D-31	PROTECTIVE PLATE	1	
D-32	GUIDE-WAYS BASE	1	
D-33	SPRING, SLIDING ARM	2	1.2 ^d x 146L x 1.2 ^p x 119
D-34	SCREW, SLIDING ARM SPRING	2	5/16" ^φ x 1 1/2" L
D-35	BOLT, HEAD BODY	4	3/8" ^φ x 1 1/2"
D-36	SOCKET CAP SCREW, SLOT KEY	2	3/8" ^φ x 1 1/4"

BODY, PULLEY AND MAIN SHAFT EXPLODED VIEW (FIG. 5)

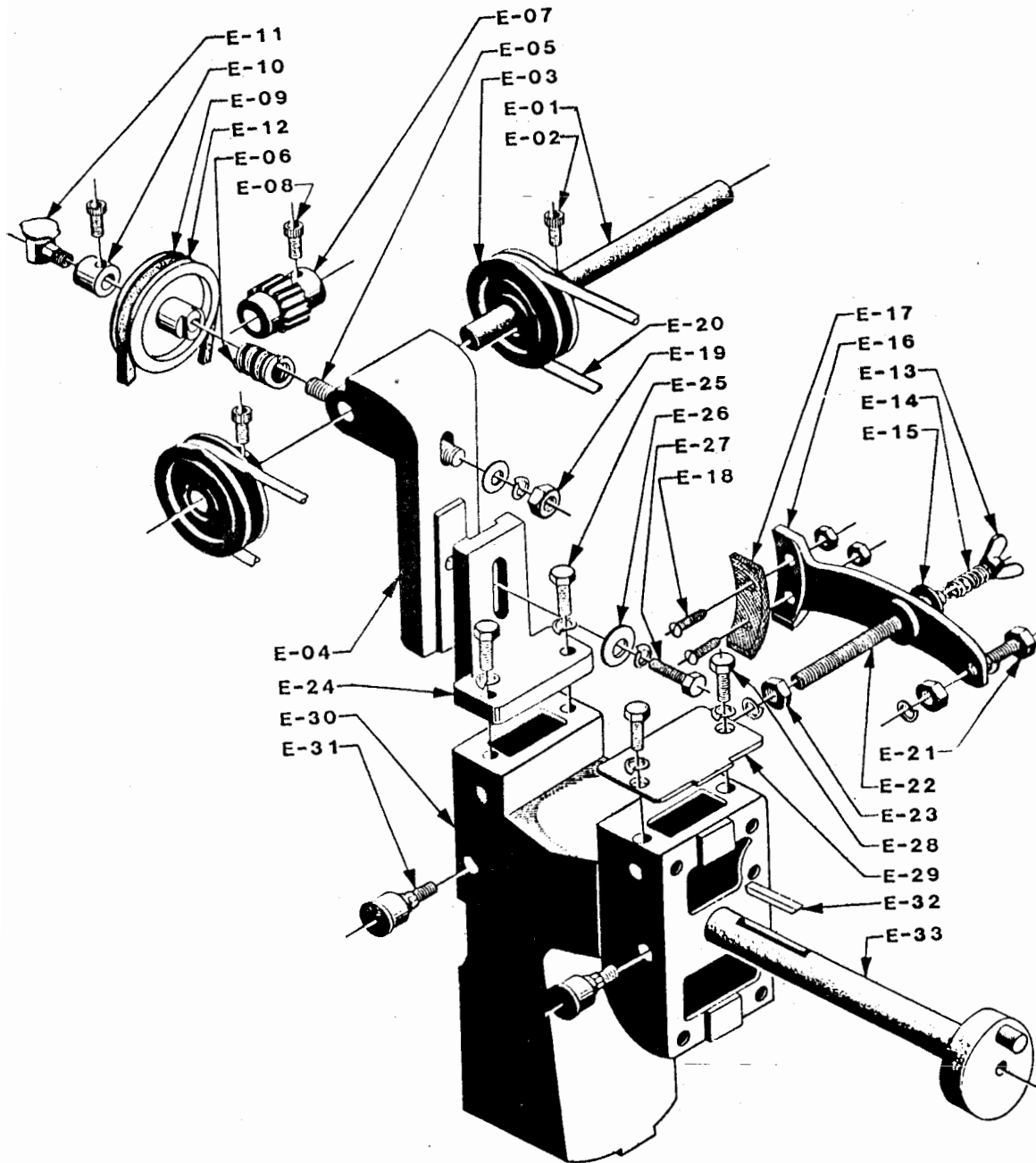

HIKER**Figure 5 Parts List**

ITEM NO	DESCRIPTION	QTY	REMARKS
E-01	PULLEY SHAFT	1	5/8" ^φ x 200
E-02	SOCKET CAP SCREW, PULLEY	2	5/16" ^φ x 3/4"
E-03	PULLEY	2	
E-04	PULLEY STAND	1	
E-05	WORM GEAR SHAFT	1	
E-06	WORM GEAR	1	
E-07	BUSHING-SHAFT GEAR	1	
E-08	SOCKET CAP SCREW, BUSHING SHAFT	1	5/16" ^φ x 5/16"
E-09	PULLEY, WORM GEAR SHAFT	1	
E-10	OUTER COLLAR, WORM GEAR SHAFT	1	
E-11	OIL CUP	1	
E-12	PULLEY BELT	1	
E-13	THUMB-NUT	1	3/8" ^φ
E-14	COIL SPRING	1	2.3 ^d x 15 ^d x 6 ^p x 43.3 ^l
E-15	FLAT WASHER	1	3/8" ^φ
E-16	BRAKE ANCHOR	1	
E-17	BRAKE LINING	1	
E-18	SCREW, BRAKE LINING	2	3/16" ^φ x 1"L
E-19	NUT, WORM GEAR SHAFT	1	
E-20	PULLEY BELT	1	
E-21	SCREW, BRAKE ANCHOR	1	1/4" ^φ x 11/2"L
E-22	THREADED STUD, BRAKE ANCHOR	1	3/8" ^φ x 4"L
E-23	NUT, THREADED PIN	1	3/8" ^φ
E-24	SUPPORTING STAND	1	
E-25	FIXED SCREW	2	5/16" ^φ x 1"L
E-26	FLAT WASHER	1	
E-27	SCREW, SUPPORTING STAND	1	3/8" ^φ x 13/4"L
E-28	SCREW, HEAD COVER PLATE	2	5/16" ^φ x 1/2"L
E-29	COVER PLATE, HEAD	1	
E-30	HEAD BODY	1	
E-31	GREASE CUP	2	
E-32	KEY, DRIVE SHAFT	1	
E-33	DRIVE SHAFT	1	

CLUTCH SYSTEM EXPLODED VIEW (OLD TYPE) (FIG. 8)



圖8 零件表

件號 Item No.	名 稱 Description	數量 Qty	附 記 Remarks
H-01	黃油杯GREASE CUP	1	
H-02	固定螺絲SOCKET CAP SCREW, OUT COLLAR	1	5/16"φ×1/2"ℓ
H-03	固定環套OUTER COLLAR, FLYWHEEL	1	1 1/4"φ×1"φ×16"
H-04	飛輪FLYWHEEL	1	A-74
H-05	皮帶FLYWHEEL BELT	1	
H-06	飛輪離合卡梢INSERT, FLYWHEEL	2	
H-07	固定螺絲SCREW, CLUTCH CAM	2	3/8"φ×1"ℓ
H-08	離合器CLUTCH CAM	1	
H-09	曲桿OUTRE RING FLANGE, CRANK	1	
H-10	離合梢CAM KEY, CLUTCH	1	
H-11	頂離合梢彈簧SPRING, CAM KEY	1	1.2"×10"×4.3"×38ℓ
H-12	離合梢止擋片COVER CAM KEY SPRING	1	
H-13	固定螺絲FIXED SCREW	2	1/4"φ×1/2"ℓ
H-14	曲桿滑條連接梢心PIN SCEW, OUTER RING FLANGE	1	5/16"φ×2"ℓ
H-15	固定螺絲SCREW, SQUARE ROD	1	5/16"φ×3/4"ℓ
H-16	四角連桿SQUARE CONNECTING ROD	1	
H-17	固定螺絲THREADED PIN, SQUARE ROD	1	5/16"φ×1"ℓ
H-18	螺帽NUT, THREADED PIN	1	5/16"φ

CLUTCH SYSTEM EXPLODED VIEW (NEW TYPE) (FIG. 9)

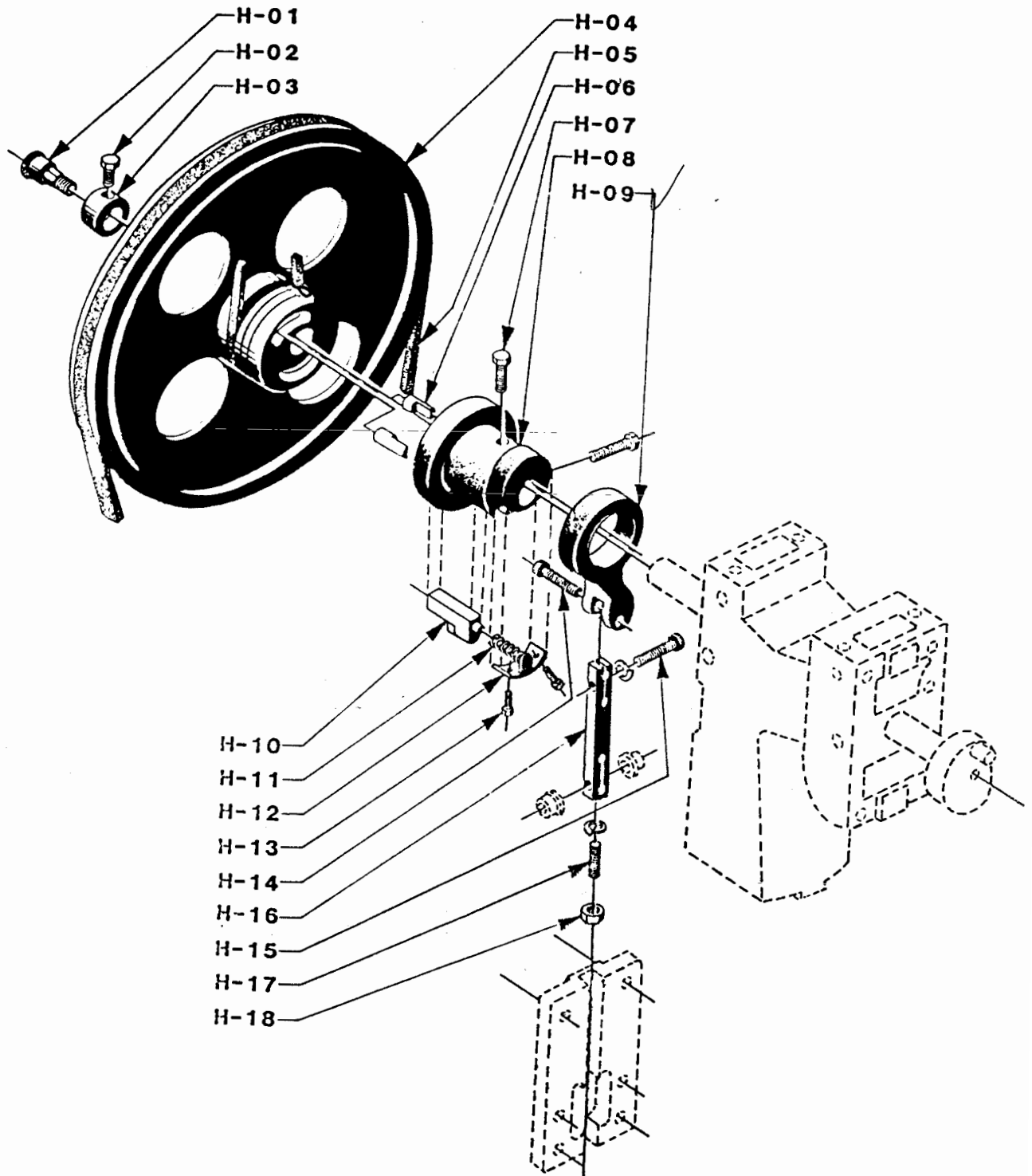

圖9 零件表

件號 Item No.	名稱 Description	數量 Qty	附記 Remarks
I-03	鋼珠護蓋COVER, ROLLER	1	
I-04	反轉控制環CONTROL RING, COUNTER CLOCKWISE	1	1/4"×5 l
I-05	鋼珠ROLLER	1	
I-07	鋼套STEEL SLEEVE	1	
I-08	軸承BEARING	2	6007#
I-09	環墊RING	1	
I-10	飛輪皮帶FLYWHEEL BELT	1	A-74
I-11	大飛輪FLYWHEEL	1	
I-12	飛輪環FLYWHEEL RING	1	
I-13	定位梢FLYWHEEL STEEL PIN	1	1/4"×18 l
I-14	飛輪內墊片DRIVE WHEEL THRUST PLATE	1	
I-15	離合器控制鋼珠CLUTCH ROLL	7	5/16"×18 l
I-16	七齒棘輪CLUTCH CAM	1	
I-17 ✓	離合器外殼CLUTCH CAGE	1	
I-18	彈簧SPRING	1	2.7°×60.5 l
I-19	阻擋片BACK STOP INSERT	1	
I-20 ✓	固定環CLUTCH COLLAR	1	
I-22	剎車調整螺絲BRAKE ADJUSTING SCREW	1	5/16"×3 1/2" l
I-23	剎車彈簧BRAKE SPRING	1	2°×5.6°×39 l ×7圈
I-24	剎車弓仔FRONT FRICTION BRAKE	1	
I-25	剎車皮FRICTION BRAKE FELT	2	
I-26	剎車弓仔FRONT FRICTION BRAKE	1	
I-27 ✓	剎車器CAM	1	
I-28 ✓	曲桿OUTER RING FLANGE, CRANK	1	
I-29 ✓	主軸SPINELD	1	
I-32	固定梢FIXED PIN	1	6.1°×30 l
I-34	鋼墊片STEEL PIECE	1	5°×32 l
I-35	優力膠墊RUBBER SEAT	1	
I-36	支架RIGHT ANGLE PLATE	1	
I-37	固定梢SPRING PIN	1	5.0°×32 l
I-38	活動拉勾座CLUTCH LEVER	1	
I-39	離合器拉勾UPPER TREADLE ROD	1	
I-40	彈簧軸ROUND-HEADED PIN	1	
I-41	彈簧SPRING	1	0.9°×3.3°×65 l ×20圈
I-43	彈簧梢INNER SPRING PIN	1	3°×16.6 l
I-45	固定梢PIN	1	
I-46	固定梢FIXED PIN	1	
I-47	拉勾座CLUTCH LEVER SEAT	1	
I-48 ✓	彈簧SPRING	1	
I-49 ✓	拉勾控制片CONTROL PLATE	1	
I-50 ✓	離合枝CLUTCH SUPPORT	1	
I-53 ✓	固定螺絲SCREW, SPINDLE	1	
I-54 ✓	直角座RIGHT ANGLE SEAT	1	
I-55 ✓	固定柱SQUARE BAR	1	
I-58 ✓	支架POST SUPPORT	1	
I-60 ✓	支架固定板POST SUPPORT SEAT	1	

HEAD, COMPONENT CASE SYSTEM EXPLODED VIEW (FIG. 10)

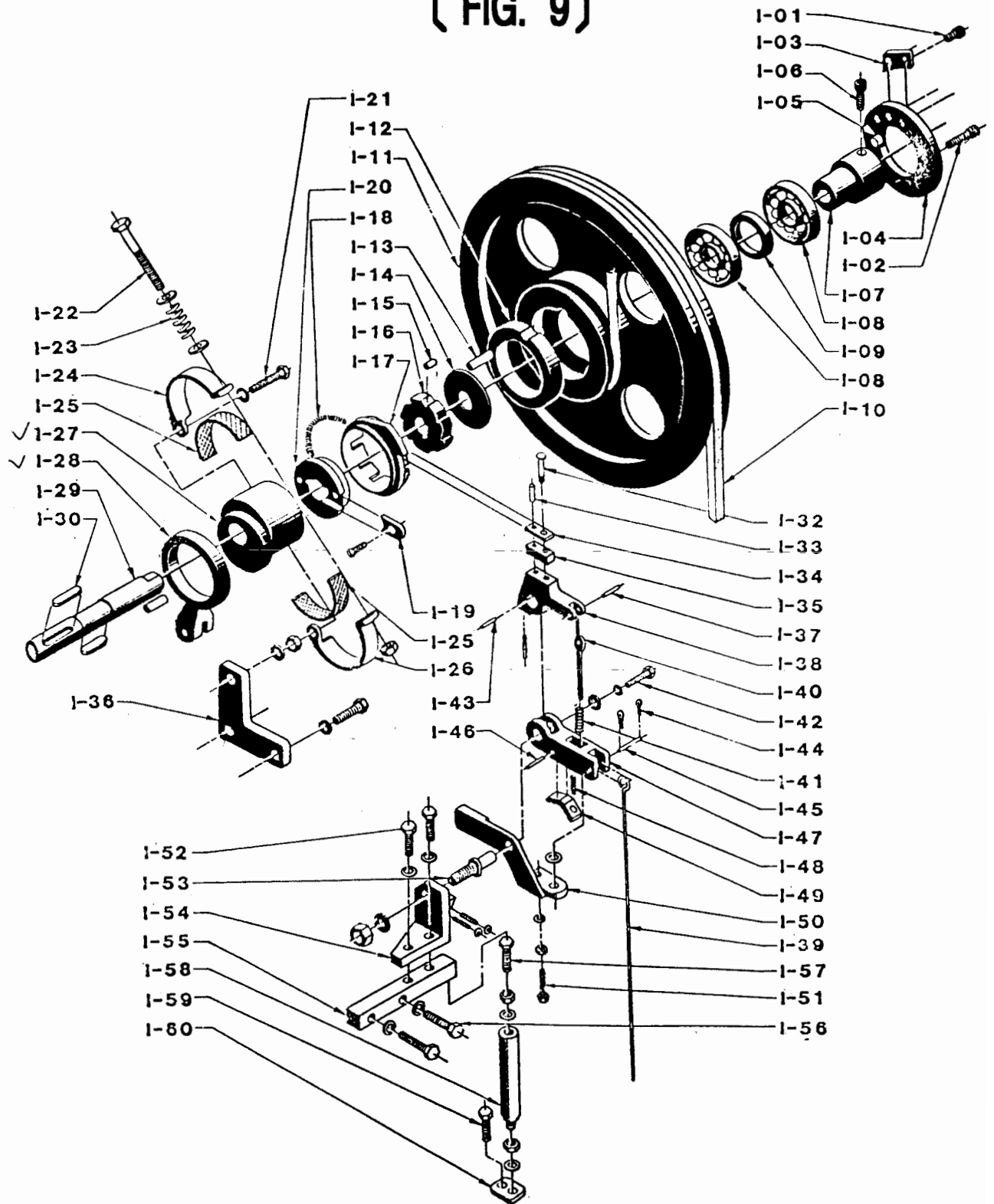

圖10 零件表

件號 Item No.	名稱 Description	數量 Qty	附記 Remarks
J-02	拍動叉PATting CONTROL PLATE	1	1/4" × 1/2" l
J-03	拍動頭PATting CONTROL	1	
J-04	圓梢PIN	1	3/8" × 30 l
J-05	固定螺絲FIXED SCREW	1	
J-06	拍動頭輪心ROLLER PIN	1	
J-07	拍動頭滑輪PATting CONTROL ROLLER	1	
J-08	四角銅仁SQUARE GUIDE BUSHING	1	
J-09	頂流道螺絲ADJUSTING SCREW	1	3/16" × 3" l
J-11	指示燈固定板ATTACHED PLATE	1	
J-12	定位內位軸LIGHT HOLDER SCREW	1	
J-13	定位套OUTER PIPE	1	
J-14	固定柱FIXED PIVOT	1	
J-15	連接螺柱BOLT	1	
J-16	連接柱CLAMPING BOLT	1	
J-17	燈管後罩SHELL, CONNECTOR	1	
J-18	燈座LAMP HOLDER	1	
J-19	燈管調整夾ADJUSTING CLAMP RING	1	
J-20	燈管LAMP CASE	1	
J-21	凸透鏡LAMP LENS	1	
J-22	固定透鏡螺姆LAMP CAP	1	
J-23	三節心銑仁MOVING GUIDE, THREE-STEP-PIN	1	
J-24	前蓋COMPONENT CASE SIDE PLATE	1	
J-27	名牌貼紙NAME PLATE	1	
J-29	彈簧勾片HOOK PLATE, THREE-STEP-PIN	1	
J-30	四角斗COMPONENT CASE	1	
J-31	方型滑動桿 (四角滑條) SQUARE SLIDING BAR (LEFT)	1	
J-32	調整螺絲ADJUSTING SCRES, CLAMP HOLDER	1	5/16" × 2 1/2" l
J-34	滑條定位調整匣塊CLAMP HOLDER, SQUARE ROD	1	
J-35	固定螺絲FIXED SCREW	1	5/16" × 1/2" l
J-36	滑條蓋板SIDE PLATE SLIDING BAR	1	
J-37	固定螺絲FIXED SCREW	4	1/4" × 1/2" l
J-38	彈簧TRACK PLATE, SPRING	1	7.5° × 147 l
J-40	固定螺絲FIXED SCREW	1	1/4" × 1" l
J-41	L型固定夾頭座BEARER, SLIDING BAR	1	
J-42	固定螺絲FIXED SCREW	1	1/4" × 1/2" l
J-43	上夾頭座UPPER JAW SEAT	1	
J-44	9字型拉勾9-TYPE HOOK	1	
J-45	固定螺絲SCREW, HOOK	4	5/16" × 1" l
J-46	夾頭彈簧片UPPER JAW ARM	2	
J-48	夾頭彈簧片LEAF SPRING, UPPER JAW	2	
J-49	上夾頭組UPPER JAW (RECEIVER)	1	
J-51	彈簧固定板螺絲THREADED PIN	1	
J-52	三節心軸THREE-STEP-PIN	1	
J-53	固定螺絲FIXED SCREW	1	5/16" × 1/2" l
J-54	上模UPPER DIE	1	
J-55	調整夾頭L型固定板 (上止) L-TYPE PLATE	1	
J-56	螺絲ADJUSTING SCREW, SQUARE ROD	1	5/16" × 2 1/2" l

RIGHT FEEDING SYSTEM EXPLODED VIEW (FIG. 11)

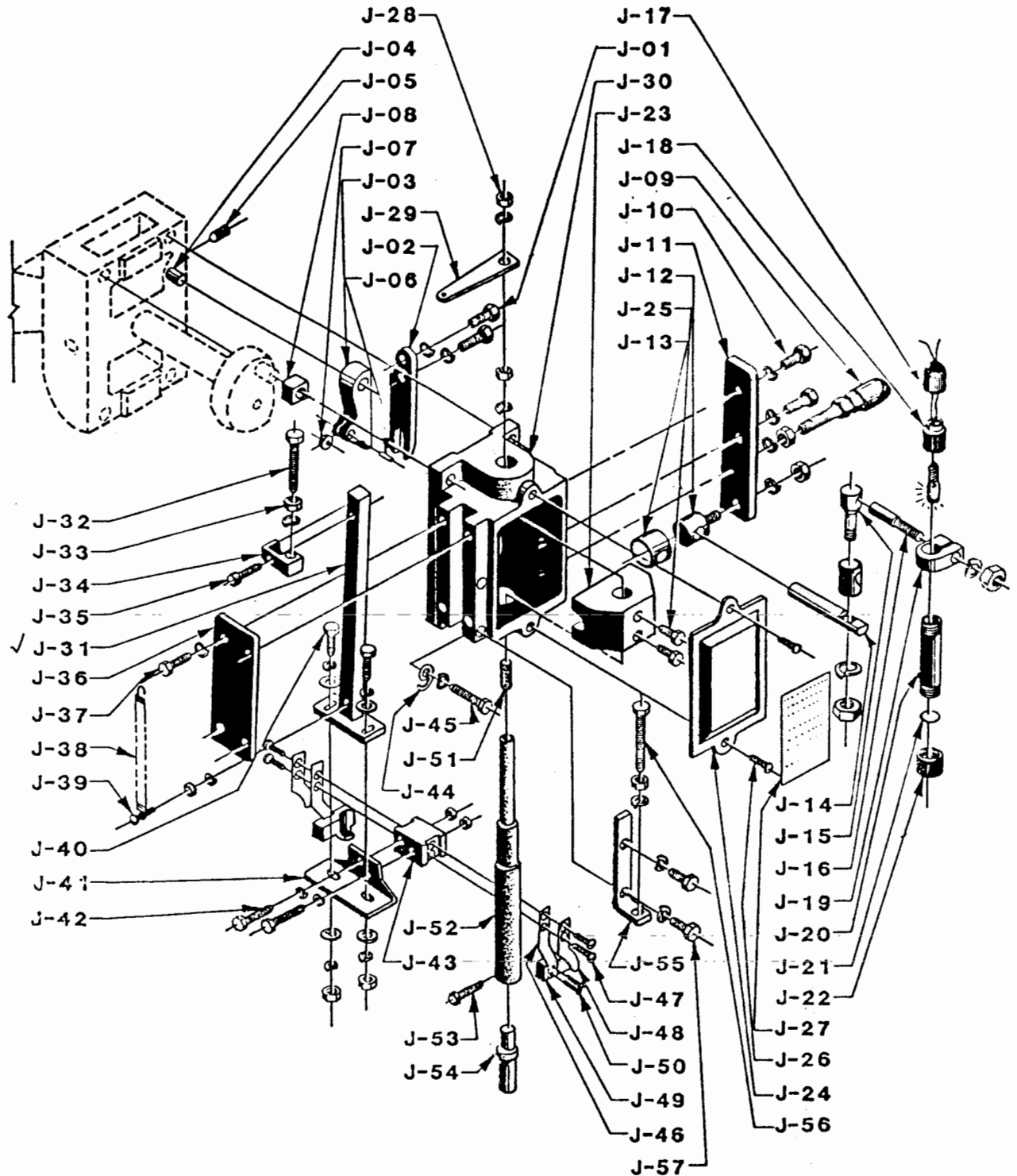

圖11 零件表

件號 Item No.	名稱 Description	數量 Qty	附記 Remarks
K-01	漏斗入口固定螺絲SOKET CAP SCREW, HOPPER	2	1/4"×1"l
K-02	漏斗入口HOPPER	1	
K-03	四角板LOADING CHUTE PLATE 加裝培林	1	
K-05	螺帽NUT	6	
K-06	螺紋套固定螺母RING NUT, THREADED PIPE	2	
K-07	把手HANDLE KNOB	1	
K-08	清潔孔塞壓片CONNECTING PIECE, CLEANING PLUG	1	
K-09	清潔孔塞CLEANING PLUG	1	
K-10	SCREW	1	1/4"×1 1/4"l
K-11	墊環RING	1	3/8"×7.0"×15"
K-12	固定螺絲FIXED SCREW	1	5/16"×1"l
K-13	頂心板LEFT (RIGHT) EDGE SUPPORT	2	右左各一
K-14	頂心板固定螺絲SIDE SCREWS	4	1/4"×3/4"l
K-15	頂心螺絲ADJUSTING SCREW, SUSPENSION BRACKET	2	
K-16	橡膠油封RUBBER SEAL	2	
K-17	選料齒輪心軸SPINDLE (LONG)	1	
K-18	螺紋套THREADED PIPE, SPINDLE 用培林	1	
K-19	四角環HOPPER CONE RING SHIELD	1	1組
K-20	固定螺絲FIXED SCREW	6	1/4"×1 1/4"l
K-21	撥片STIRRERS	3	
K-22	SCREW, STIRRED PLATE	3	1/4"×3/8"l
K-23	特殊墊片SPECIAL WASHER	1	
K-24	選料齒輪HOPPER CONE	1	視鈕釦而定
K-25	圓皮帶ROUND BELT	2	左右各一
K-26	皮帶輪PULLEY	1	
K-27	傳力圓套THREADED RING, SPINDLE	1	
K-28	彈簧COIL SPRING, SPINDLE	1	37l×3.75"×9"
K-29	壓花螺母RING NUT, SPINDLE	1	
K-31	流道吊架SUSPENSION BRACKET, TRACK	1	
K-32	固定螺絲FIXED SCREW	2	1/4"×1"l
K-33	直角接片TRACK HOLDER PLATE	1	
K-34	螺帽NUT	2	
K-35	支架BRACKET, LOADING CHUTE PLATE	1	
K-36	固定螺絲FIXED SCREW	2	
K-38	FIXED SCREW, LOADING CHUTE PLATE	2	3/8"×1 1/4"l
K-39	流道組TRACK SECTIEN	1	
K-40	流道固定螺絲FIXED SCREW, TRACK SECTION	2	1/4"×1"l
K-41	控制條CONTROL BLOCK, EXIT CONTROLLER	1	
K-42	流道控制架CAGE SEAT	1	
K-43	拍動心PATting ROD	1	
K-44	流道拉簧TRACK SPRING	1	1"×11.5"×72l
K-45	控制勾固定梢EXIT CONTROLLER PIN	1	
K-46	控制勾EXIT CONTROLLER PIECE	2	
K-47	拍動叉PATting SPANNER PLATE	1	(短)
K-48	彈簧EXIT CONTROLLER SPRING	2	0.5"×1.5"×4.5"×18l
K-49	固定螺絲FIXED SCREW	2	
K-50	蓋板EXIT CONTROLLER CAGE	1	
K-52	鋼環STEEL RING	1	





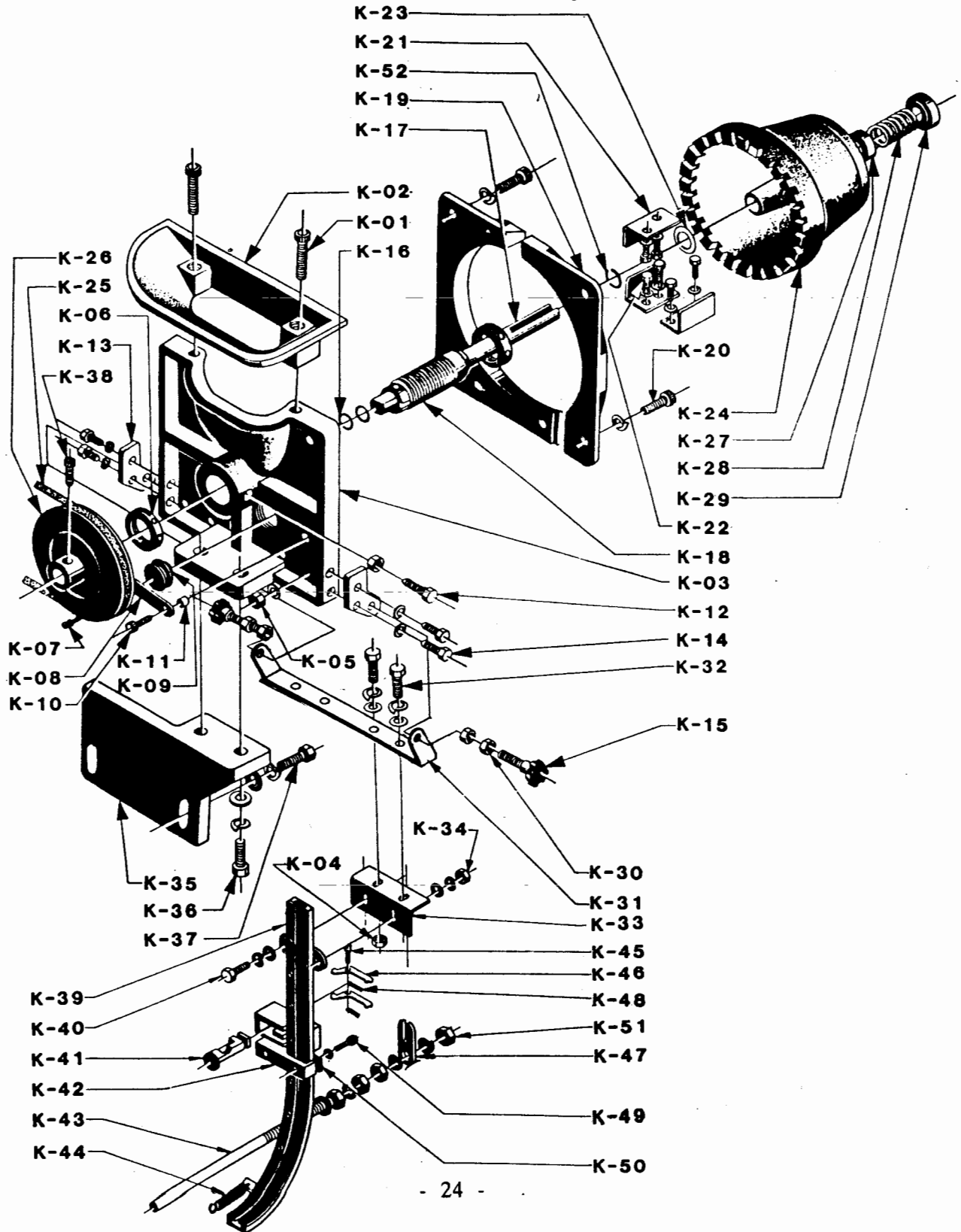
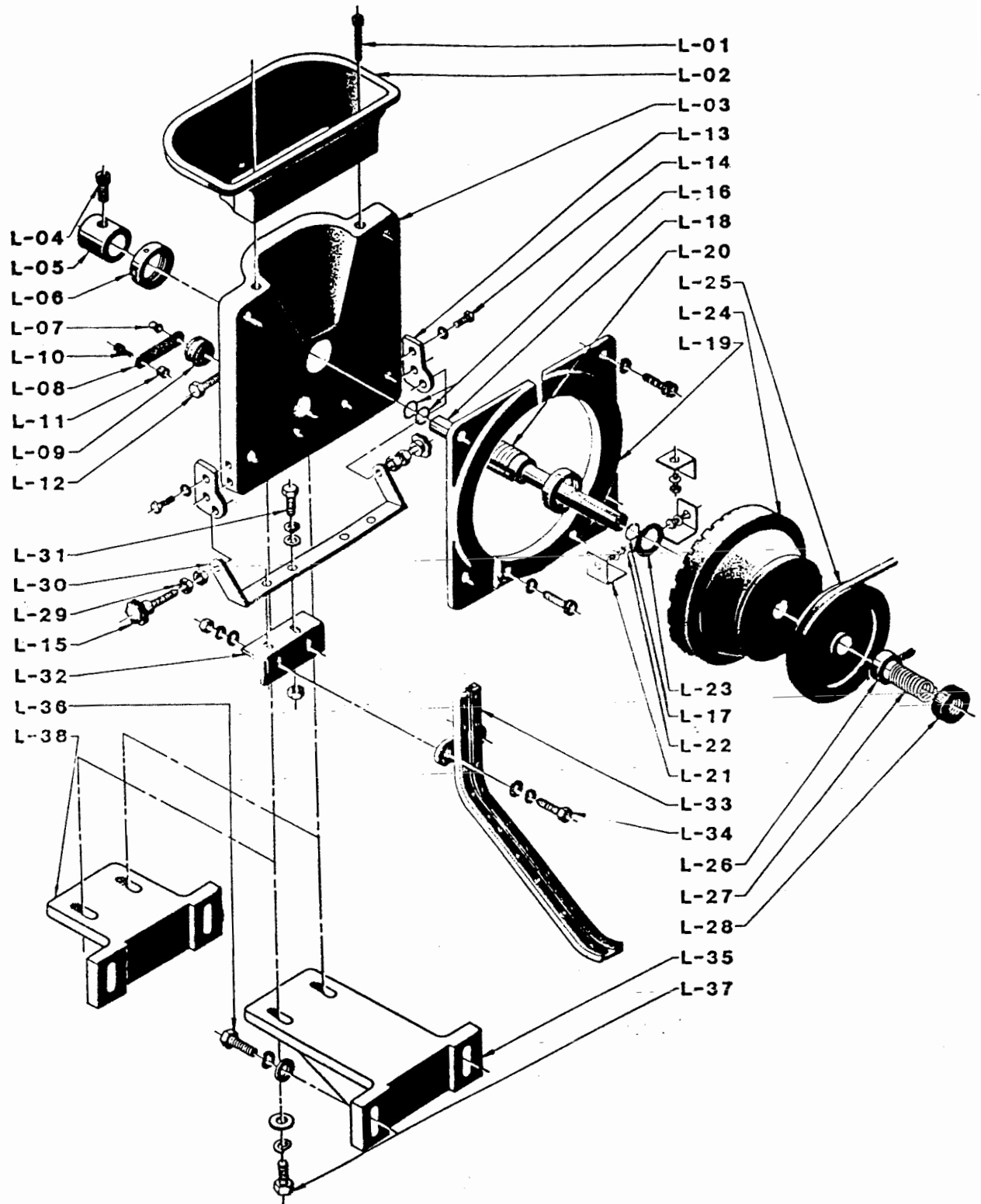

LEFT FEEDING SYSTEM EXPLODED VIEW (FIG. 12)



HIKER**Figure 12 Parts List**

ITEM NO	DESCRIPTION	QTY	REMARKS
L-01	SOCKET CAP SCREW, HOPPER	2	1/4" x 1"L
L-02	HOPPER	1	
L-03	LOADING CHUTE PLATE	1	
L-04	FIXED SCREW	1	5/16" x 3/4"L
L-05	RETAINING SLEEVE, SPINDLE	1	1 1/4" x 5/8" x 30L
L-06	RING NUT THREADED PIPE	2	
L-07	HANDLE KNOB	1	
L-08	CONNECTING PIECE, CLEANING PLUG	1	
L-09	CLEANING PLUG	1	
L-10	SCREW	1	1/4" x 1 1/4"L
L-11	RING	1	3/8" x 7.0f x 15L
L-12	FIXED SCREW	1	5/16" x 1"L
L-13	LEFT/RIGHT EDGE SUPPORT	2	
L-14	SIDE SCREWS	4	1/4" x 3/4"L
L-15	ADJUSTING SCREW, SUSPENSION BRACKET	2	
L-16	RING LOCK	2	
L-17	RUBBER SEAL	1	
L-18	SPINDLE(SHORT)	1	
L-19	HOPPER CONE RING SHIELD	1	OR MODEL 100019
L-20	THREADED PIPE, SPINDLE	1	
L-21	STIRRERS	3	
L-22	SCREW STIRRERS	3	1/4" x 3/8"L
L-23	SPECIAL WASHER	1	
L-24	HOPPER CONE	1	depend on button size
L-25	PULLEY	1	
L-26	THREADED RING, SPINDLE	1	1 1/4" x 16" x 10L
L-27	COIL SPRING, SPINDLE	1	3.75 ^d X 9 ^o x 37 x 5
L-28	RING NUT SPINDLE	1	
L-29	NUT	4	
L-30	SUSPENSION BRACKET	1	
L-31	FIXED NUT	2	1/4" x 1"
L-32	TRACK HOLDER PLATE	1	
L-33	TRACK SECTION	1	
L-34	TRACK PLATE	2	1/4" x 1"
L-35	BRACKET (LONG LOADING CHUTE PLATE)	1	
L-36	FIXED SCREW BRACKET	2	3/8" x 1 1/4"L
L-37	FIXED SCREW, LOADING-CHUTE-PLATE	2	3/8" x 1 1/4"L
L-38	SUPPORTER	1	

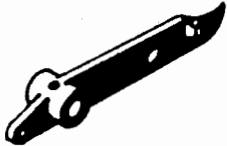
正常損耗另件表
Normal Wornout Parts List

零 件 圖 Parts	件 號 Item No.	數 量 Qty	損 耗 (工 / 時) Worn Out (W/Hr)	附 記 Remarks
	J-08	1	9000Hrs	<p style="text-align: center;">注意飛輪離 合器之定期保養</p> <p style="text-align: center;">WITH CARE OF THE FLYWHEEL, CLUTCH, AND SHAFT LUBRIC- ATING PERFORMANCE IN REGULAR MAINTENANCE.</p>
	H-06	2	3000Hrs	
	H-10	1	3000Hrs	
	J-23	1	3000Hrs	
	G-10	1	3000Hrs	
	J-54	1		
	C-01	1		

WIRE DIAGRAM

